

cell chemistry: Li-Ion
cell size: AA (14500)
cell type: round cell

Conditions

nominal output voltage: 1.5 V

capacity

nominal: 3500 mAh discharge at 0.2C (700mA)
 2800 mAh discharge at 0.5C (1700mA)
 minimum: 3250 mAh discharge at 0.2C
 ta: 20°C; EV(Discharge End Voltage): 0.9V

discharge

nom. discharge current: 640 mA ta: 0...45°C
 max. continuous discharge current: 2000 mA
 peak discharge current: 3 A < 10s

discharge diagram:
(200mA constant)

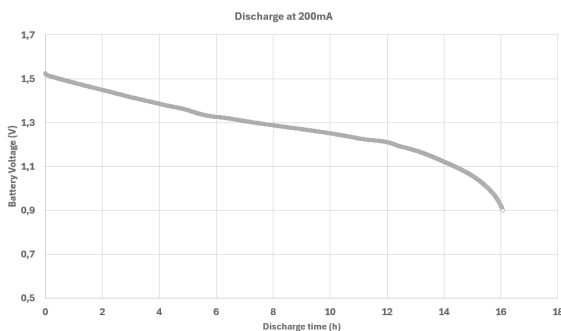

charge

supply voltage: 5 V ± 0.25V
 charge current: 320 mA ± 10%
 charge time: 6 h ± 0.5h

built-in li-ion battery: 3.85 V / 1250mAh
 energy: 4.81 Wh

output protection functions

overload cut-off current: 3 A ± 0.5A
 short circuit protection: yes
 deep discharge protection
 cut-off voltage of int. battery: 2.6 V ± 0.3V
 internal resistance (DC): 40...70 mOhms

life time expectance

(C>70% of min. capacity) ≥ 1500 cycles at 0.2C discharge rate

self discharge:

≤ 2 %/month at 20°C
 ≤ 5 %/month at 30°C
 ≤ 10 %/month at 40°C

ambient temperature range:

0...45 °C charge
 - 20...60 °C discharge
 storage time (full battery):
 - 20...25 °C max. 36 months
 - 20...45 °C max. 12 months

mechanical specifications

cell dimensions (incl. sleeve)
 diameter d1: 14.5 - 0.7 mm
 diameter d2: 5 ± 0.5 mm
 height h1: 50.5 - 1 mm
 height h2: 1.5 ± 0.5 mm
 weight: 21 ± 1.5 g

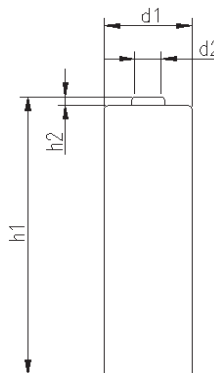

	ANSMANN Specifications for model:	AA (14500) Li-Ion Battery 1.5V 3500mAh
	data sheet no. / part no.	1312-0042
	s.n.	705163
	author / date	TG / 04.11.2025